

Esempi di cuscinetti per sistemi lineari - Profilo B

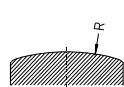

Profilo B

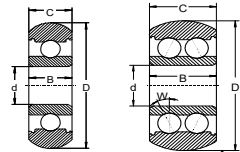
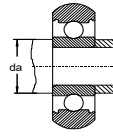

Gabbie e anelli di tenuta

- Disponibile
- Possibile (quantita minima)
- Fuori program

Codice dei profili

- B : Profilo convesso
- K : Anello decentrato
- M : Anello piu largo dell'altro
- S : Anello in acciaio inossidabile ACD34
- T : Due corone di sfere
- X : Forme che non possono essere identificate con gli altri codici



Dimensioni d	D	B	C	Sigla	Angolo di contatto W °	Caratteristiche del profilo			Velocità di riferimento		Coefficienti di carico		Dimensioni delle parti adiacenti da min		Massa ~ gr	Sigla	Gabbia Y						Gabbia J						Gabbia T9H						Gabbia TBH					
						R max mm	giri/min x 1'000 Olio	giri/min x 1'000 Grasso	Schermo strisciante e	Din. Cr kN	Sta. Cor kN	mm	mm	Anelli di tenuta						Anelli di tenuta						Anelli di tenuta						Anelli di tenuta								
4	13	5	5	B400	-	9,5	45	38	24	1,300	0,486	5,6	11,4	1,6	B400	[Legend]	[Legend]	[Legend]	[Legend]	[Legend]	[Legend]	[Legend]	[Legend]	[Legend]	[Legend]	[Legend]	[Legend]	[Legend]	[Legend]	[Legend]	[Legend]	[Legend]	[Legend]	[Legend]	[Legend]					
	13	5	5	BS4S00	-	75	45	38	24	1,300	0,486	5,6	11,4	3,2	BS4S00	[Legend]	[Legend]	[Legend]	[Legend]	[Legend]	[Legend]	[Legend]	[Legend]	[Legend]	[Legend]	[Legend]	[Legend]	[Legend]	[Legend]	[Legend]	[Legend]	[Legend]	[Legend]	[Legend]	[Legend]					
5	16	5	5	BX500	-	8,05	43	36	22	1,880	0,681	7,0	14,0	4,9	BX500	[Legend]	[Legend]	[Legend]	[Legend]	[Legend]	[Legend]	[Legend]	[Legend]	[Legend]	[Legend]	[Legend]	[Legend]	[Legend]	[Legend]	[Legend]	[Legend]	[Legend]	[Legend]	[Legend]	[Legend]	[Legend]				
	16	6	5	B5M00	-	8	43	36	22	1,880	0,681	7,0	14,0	4,8	B5M00	[Legend]	[Legend]	[Legend]	[Legend]	[Legend]	[Legend]	[Legend]	[Legend]	[Legend]	[Legend]	[Legend]	[Legend]	[Legend]	[Legend]	[Legend]	[Legend]	[Legend]	[Legend]	[Legend]	[Legend]	[Legend]				
6	19	6	6	B600	-	500	38	32	22	2,460	1,050	8,0	17,0	8,4	B600	[Legend]	[Legend]	[Legend]	[Legend]	[Legend]	[Legend]	[Legend]	[Legend]	[Legend]	[Legend]	[Legend]	[Legend]	[Legend]	[Legend]	[Legend]	[Legend]	[Legend]	[Legend]	[Legend]	[Legend]	[Legend]				
	22,8	7	7	B700	-	4,762	38	32	22	2,460	1,050	9,0	17,0	15	B700	[Legend]	[Legend]	[Legend]	[Legend]	[Legend]	[Legend]	[Legend]	[Legend]	[Legend]	[Legend]	[Legend]	[Legend]	[Legend]	[Legend]	[Legend]	[Legend]	[Legend]	[Legend]	[Legend]	[Legend]	[Legend]				
	22,9	7	7	B702	-	4,6	38	32	22	2,460	1,050	9,0	17,0	14	B702	[Legend]	[Legend]	[Legend]	[Legend]	[Legend]	[Legend]	[Legend]	[Legend]	[Legend]	[Legend]	[Legend]	[Legend]	[Legend]	[Legend]	[Legend]	[Legend]	[Legend]	[Legend]	[Legend]	[Legend]	[Legend]				
8	22	7	7	B800	-	500	36	30	20	3,280	1,360	10,0	20,0	12	B800	[Legend]	[Legend]	[Legend]	[Legend]	[Legend]	[Legend]	[Legend]	[Legend]	[Legend]	[Legend]	[Legend]	[Legend]	[Legend]	[Legend]	[Legend]	[Legend]	[Legend]	[Legend]	[Legend]	[Legend]	[Legend]	[Legend]			
	22	7	7	B804	-	11	36	30	20	3,280	1,360	10,0	20,0	12,4	B804	[Legend]	[Legend]	[Legend]	[Legend]	[Legend]	[Legend]	[Legend]	[Legend]	[Legend]	[Legend]	[Legend]	[Legend]	[Legend]	[Legend]	[Legend]	[Legend]	[Legend]	[Legend]	[Legend]	[Legend]	[Legend]				
	22	8	7	B8M00	-	500	38	32	22	2,460	1,050	10,0	20,0	13	B8M00	[Legend]	[Legend]	[Legend]	[Legend]	[Legend]	[Legend]	[Legend]	[Legend]	[Legend]	[Legend]	[Legend]	[Legend]	[Legend]	[Legend]	[Legend]	[Legend]	[Legend]	[Legend]	[Legend]	[Legend]	[Legend]	[Legend]			
	22	14	14	BMT8K00 <small>2 file di sfere</small>	-	100	36	30	20	5,050	2,710	10,0	20,0	21,7	BMT8K00	[Legend]	[Legend]	[Legend]	[Legend]	[Legend]	[Legend]	[Legend]	[Legend]	[Legend]	[Legend]	[Legend]	[Legend]	[Legend]	[Legend]	[Legend]	[Legend]	[Legend]	[Legend]	[Legend]	[Legend]	[Legend]	[Legend]			
22	14	22	BMT800 <small>2 file di sfere</small>	-	100	36	30	20	5,050	2,710	10,0	20,0	24,5	BMT800	[Legend]	[Legend]	[Legend]	[Legend]	[Legend]	[Legend]	[Legend]	[Legend]	[Legend]	[Legend]	[Legend]	[Legend]	[Legend]	[Legend]	[Legend]	[Legend]	[Legend]	[Legend]	[Legend]	[Legend]	[Legend]	[Legend]	[Legend]			
22	14	22	SBMT800 <small>2 file di sfere</small>	-	100	36	30	20	5,050	2,710	10,0	20,0	24,5	SBMT800	[Legend]	[Legend]	[Legend]	[Legend]	[Legend]	[Legend]	[Legend]	[Legend]	[Legend]	[Legend]	[Legend]	[Legend]	[Legend]	[Legend]	[Legend]	[Legend]	[Legend]	[Legend]	[Legend]	[Legend]	[Legend]	[Legend]	[Legend]			
9	24	7	7	B900	-	40	36	30	19	3,670	1,640	11,0	22,0	15,1	B900	[Legend]	[Legend]	[Legend]	[Legend]	[Legend]	[Legend]	[Legend]	[Legend]	[Legend]	[Legend]	[Legend]	[Legend]	[Legend]	[Legend]	[Legend]	[Legend]	[Legend]	[Legend]	[Legend]	[Legend]	[Legend]				
	26	8	8	B901	-	200	34	28	18	4,580	1,970	11,0	24,0	20,2	B901	[Legend]	[Legend]	[Legend]	[Legend]	[Legend]	[Legend]	[Legend]	[Legend]	[Legend]	[Legend]	[Legend]	[Legend]	[Legend]	[Legend]	[Legend]	[Legend]	[Legend]	[Legend]	[Legend]	[Legend]	[Legend]				
10	32	9	9	B1000	-	32	32	26	17	5,970	2,630	14,0	28,0	57,5	B1000	[Legend]	[Legend]	[Legend]	[Legend]	[Legend]	[Legend]	[Legend]	[Legend]	[Legend]	[Legend]	[Legend]	[Legend]	[Legend]	[Legend]	[Legend]	[Legend]	[Legend]	[Legend]	[Legend]	[Legend]	[Legend]	[Legend]			
	34,8	11	11	B1001	-	7,1	32	26	17	5,970	2,630	14,0	26,0	54,5	B1001	[Legend]	[Legend]	[Legend]	[Legend]	[Legend]	[Legend]	[Legend]	[Legend]	[Legend]	[Legend]	[Legend]	[Legend]	[Legend]	[Legend]	[Legend]	[Legend]	[Legend]	[Legend]	[Legend]	[Legend]	[Legend]	[Legend]			
	35,6	11	11	B1003	-	7,1	32	26	17	5,970	2,630	14,0	27,0	54,5	B1003	[Legend]	[Legend]	[Legend]	[Legend]	[Legend]	[Legend]	[Legend]	[Legend]	[Legend]	[Legend]	[Legend]	[Legend]	[Legend]	[Legend]	[Legend]	[Legend]	[Legend]	[Legend]	[Legend]	[Legend]	[Legend]	[Legend]			
	35,6	11	11	B1004	-	7,1	32	26	17	5,970	2,630	14,0	27,0	54,5	B1004	[Legend]	[Legend]	[Legend]	[Legend]	[Legend]	[Legend]	[Legend]	[Legend]	[Legend]	[Legend]	[Legend]	[Legend]	[Legend]	[Legend]	[Legend]	[Legend]	[Legend]	[Legend]	[Legend]	[Legend]	[Legend]	[Legend]			
12,7	32	9,525	9,27	B12,7M00	-	6,35	32	26	17	5,100	2,370	14,7	26,0	40	B12,7M00	[Legend]	[Legend]	[Legend]	[Legend]	[Legend]	[Legend]	[Legend]	[Legend]	[Legend]	[Legend]	[Legend]	[Legend]	[Legend]	[Legend]	[Legend]	[Legend]	[Legend]	[Legend]	[Legend]	[Legend]	[Legend]				
15	37	11	11	B1500	-	8,5	26	20	13	7,730	3,760	19,0	31,0	49,5	B1500	[Legend]	[Legend]	[Legend]	[Legend]	[Legend]	[Legend]	[Legend]	[Legend]	[Legend]	[Legend]	[Legend]	[Legend]	[Legend]	[Legend]	[Legend]	[Legend]	[Legend]	[Legend]	[Legend]	[Legend]	[Legend]				

* Versione disponibile con gabbia TNH