

Single row track rollers - cylindrical and spherical

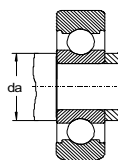
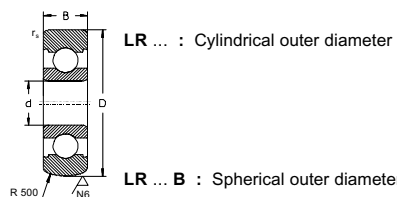

Cages and shields

- Available
- Feasible (minimum quantity)
- Out of program

d	Dimensions			Designation	Limiting speeds			Basic load ratings		Balls	Abutment dimensions da min mm inch	Mass ~ gr	Designation	Cage Y Shields						Cage T9H Shields																		
	D	B	r _s		rpm x 1'000	Dyn. Cr	Stat. Cor	Dyn. Cr	Stat. Cor					Open	Z	ZZ	RSR	2RSR	RSF	2RSF	RSV	2RSV	Open	Z	ZZ	RSR	2RSR	RSF	2RSF	RSV	2RSV							
	mm inch	mm inch	min		Oil	Grease	Contact seals	kN	kN																													
4	13	4	0.2	LR604	46	39	26	0.95	0.34	7x5/64"	5.0	10	LR604																									
	.157	.512	.157	.008							.197																											
	13	4	0.2	LR604B	46	39	26	0.95	0.34	7x5/64"	5.0	10	LR604B																									
	.512	.157	.008								.197																											
5	16	5	0.2	LR605	40	33	22	1.73	0.67	7x7/64"	6.4	10	LR605																									
	.197	.630	.197	.008							.252																											
	16	5	0.2	LR605B	40	33	22	1.73	0.67	7x7/64"	6.4	10	LR605B																									
	.630	.197	.008								.252																											
6	19	6	0.3	LR606	43	36	20	1.61	0.72	9x3/32"	8.0	10	LR606																									
	.236	.748	.236	.012							.315																											
	19	6	0.3	LR606B	43	36	20	1.61	0.72	9x3/32"	8.0	10	LR606B																									
	.748	.236	.012								.315																											
7	22	6	0.3	LR607	38	32	22	2.46	1.05	8x1/8"	9.0	10	LR607																									
	.276	.866	.236	.012							.354																											
	22	6	0.3	LR607B	38	32	22	2.46	1.05	8x1/8"	9.0	10	LR607B																									
	.866	.236	.012								.354																											
8	24	7	0.3	LR608	36	30	20	3.28	1.36	7x5/32"	10.0	20	LR608																									
	.315	.945	.276	.012							.394																											
	24	7	0.3	LR608B	36	30	20	3.28	1.36	7x5/32"	10.0	20	LR608B																									
	.945	.276	.012								.394																											
10	28	8	0.3	LR6000	34	28	18	4.58	1.97	7x3/16"	12.0	20	LR6000																									
	.394	1.102	.315	.012							.472																											
	28	8	0.3	LR6000B	34	28	18	4.58	1.97	7x3/16"	12.0	20	LR6000B																									
	1.102	.315	.012								.472																											
	32	9	0.6	LR200	32	26	17	5.97	2.63	7x7/32"	14.0	50	LR200																									
	1.260	.354	.024								.551																											
	32	9	0.6	LR200B	32	26	17	5.97	2.63	7x7/32"	14.0	50	LR200B																									
	1.260	.354	.024								.551																											

PRECISION BALL BEARINGS STANDARD AND SPECIAL

Single row track rollers - cylindrical and spherical (Continued)

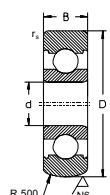

LR ... : Cylindrical outer diameter

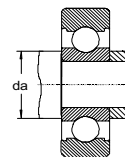

LR ... B : Spherical outer diameter

Cages and shields

- Available
- Feasible (minimum quantity)
- Out of program

d	Dimensions			Designation	Limiting speeds			Basic load ratings		Balls	Abutment dimensions		Mass	Designation	Cage Y						Cage T9H													
	D	B	r _s		rpm x '000	Dyn.	Stat.	da min	da		da	da			Open	Z	ZZ	RSR	2RSR	RSF	2RSF	RSV	2RSV	Open	Z	ZZ	RSR	2RSR	RSF	2RSF	RSV	2RSV		
	mm	mm	min					kN	kN		mm	mm	gr																					
	inch	inch									inch	inch																						
12	30	8	0.3	LR6001	32	26	17	5.10	2.37	8x3/16"	14.0	28.0	30	LR6001																				
.472	1.181	.315	.012								.551	1.102																						
	30	8	0.3	LR6001B	32	26	17	5.10	2.37	8x3/16"	14.0	28.0	30	LR6001B																				
	1.181	.315	.012								.551	1.102																						
	35	10	0.6	LR201	30	24	15	6.89	3.09	7x6mm	16.0	31.0	50	LR201																				
	1.378	.394	.024								.630	1.220																						
	35	10	0.6	LR201B	30	24	15	6.89	3.09	7x6mm	16.0	31.0	50	LR201B																				
	1.378	.394	.024								.630	1.220																						
15	35	9	0.3	LR6002	30	24	14	5.59	2.84	9x3/16"	17.0	33.0	50	LR6002																				
.591	1.378	.354	.012								.669	1.299																						
	35	9	0.3	LR6002B	30	24	14	5.59	2.84	9x3/16"	17.0	33.0	50	LR6002B																				
	1.378	.354	.012								.669	1.299																						
	40	11	0.6	LR202	26	20	13	7.73	3.76	8x6mm	19.0	36.0	70	LR202	*																			
	1.575	.433	.024								.748	1.417																						
	40	11	0.6	LR202B	26	20	13	7.73	3.76	8x6mm	19.0	36.0	70	LR202B	*																			
	1.575	.433	.024								.748	1.417																						
17	40	10	0.3	LR6003	28	22	13	6.00	3.25	10x3/16"	19.0	38.0	70	LR6003																				
.669	1.575	.394	.012								.748	1.496																						
	40	10	0.3	LR6003B	28	22	13	6.00	3.25	10x3/16"	19.0	38.0	70	LR6003B																				
	1.575	.394	.012								.748	1.496																						

* Version available with J cage